

This document, together with the concepts and designs presented herein, is intended only for the specific purpose and client for which it was prepared. Reuse of and improper reliance on this document without written authorization and adaptation by Kinney-Horn and Associates, Inc. shall be without liability to Kinney-Horn and Associates, Inc.

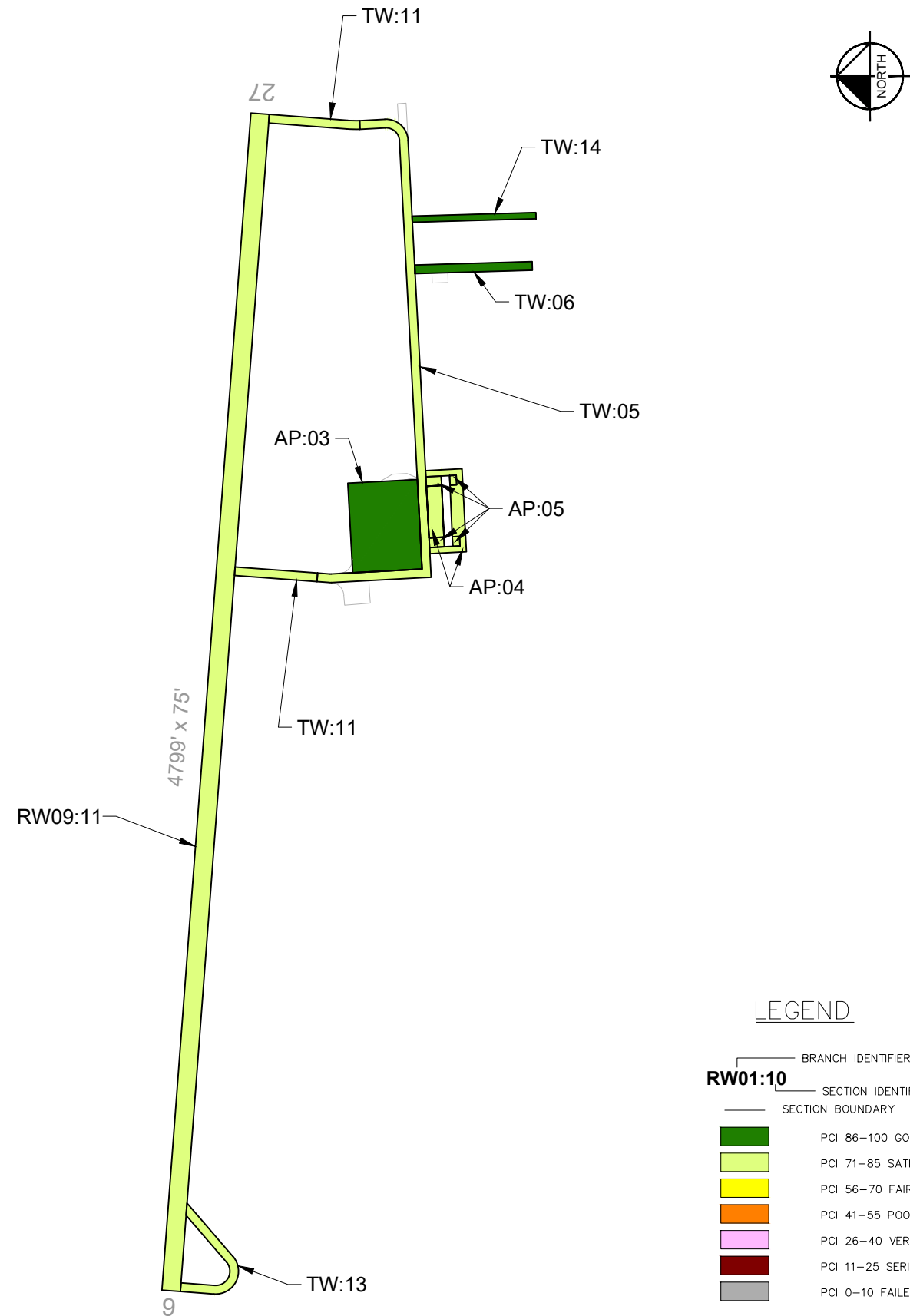

CURRENT 2024 PAVEMENT CONDITION INDEX

Branch ID	Section ID	Branch Name	Surface Type	Section Area (SF)	Approx. Age at Inspection	Last Major Work Date	Last Inspection Date	Pavement Condition Index	PCI Category
RW09	11	Runway 09-27	AAC	359,925	9.1	10/23/2015	10/12/2024	81	Satisfactory
TW	05	Taxiway	AAC	84,824	8	11/14/2016	10/12/2024	84	Satisfactory
TW	06	Taxiway	AC	16,730	8	11/14/2016	10/12/2024	87	Good
TW	11	Taxiway	AAC	24,570	9.1	10/23/2015	10/12/2024	81	Satisfactory
TW	13	Taxiway	AAC	20,458	9.1	10/23/2015	10/12/2024	83	Satisfactory
TW	14	Taxiway	AAC	12,400	8	11/14/2016	10/12/2024	86	Good
AP	03	Apron	AC	103,478	8	11/14/2016	10/12/2024	86	Good
AP	04	Apron	AC	33,550	8	11/14/2016	10/12/2024	79	Satisfactory
AP	05	Apron	AC	6,995	24.9	1/1/2000	10/12/2024	74	Satisfactory

AIRFIELD PAVEMENT WORK HISTORY

- RW09:01, TW:01 AND AP:01 ALL CONSTRUCTED OVER 12" COMPACTED SUBGRADE AT 95% COMPACTION; POOR DRAINAGE, FROST RUNWAY DESIGN BASED ON F-7 SUBGRADE. CBR=7 ASSUMED; P-402 USED IN DETERMINING MAXIMUM GROSS LOADS. AIP-001-1985, POROUS FRICTION COURSE OVERLAY OF ALL PAVEMENTS.
- AIP-002, 1994, RECONSTRUCT RUNWAY (RW09:01) AND TAXIWAY (TW:01); REHABILITATE TAXIWAY (TW:01) AND APRON (AP:01); CONSTRUCT RUNWAY TURNAROUND (TW:03).
- AIP-003, 2001, CRACK SEAL, FOG SEAL, AND REMARK ALL PAVEMENTS.
- AIP-007-2009, CRACK SEAL ALL PAVEMENTS.
- AIP-010-2015, OVERLAY RUNWAY (RW09:11) AND TURNAROUND (TW:13) AND TAXIWAYS (TW:11).
- AIP-011-2016, RECONSTRUCT APRON (AP:03, AP:04) AND TAXIWAYS (TW:05, TW:06, TW:14),
- AIP-012-2020, CRACK SEAL, SURFACE SEAL, REMARK ALL PAVEMENTS.

LEGEND

—	BRANCH IDENTIFIER
—	SECTION IDENTIFIER
—	SECTION BOUNDARY
■ (Dark Green)	PCI 86-100 GOOD
■ (Light Green)	PCI 71-85 SATISFACTORY
■ (Yellow)	PCI 56-70 FAIR
■ (Orange)	PCI 41-55 POOR
■ (Pink)	PCI 26-40 VERY POOR
■ (Red)	PCI 11-25 SERIOUS
■ (Grey)	PCI 0-10 FAILED

This document, together with the concepts and designs presented herein, is intended only for the specific purpose and client for which it was prepared. Reuse of and improper reliance on this document without written authorization and adaptation by Kinney-Horn and Associates, Inc. shall be without liability to Kinney-Horn and Associates, Inc.

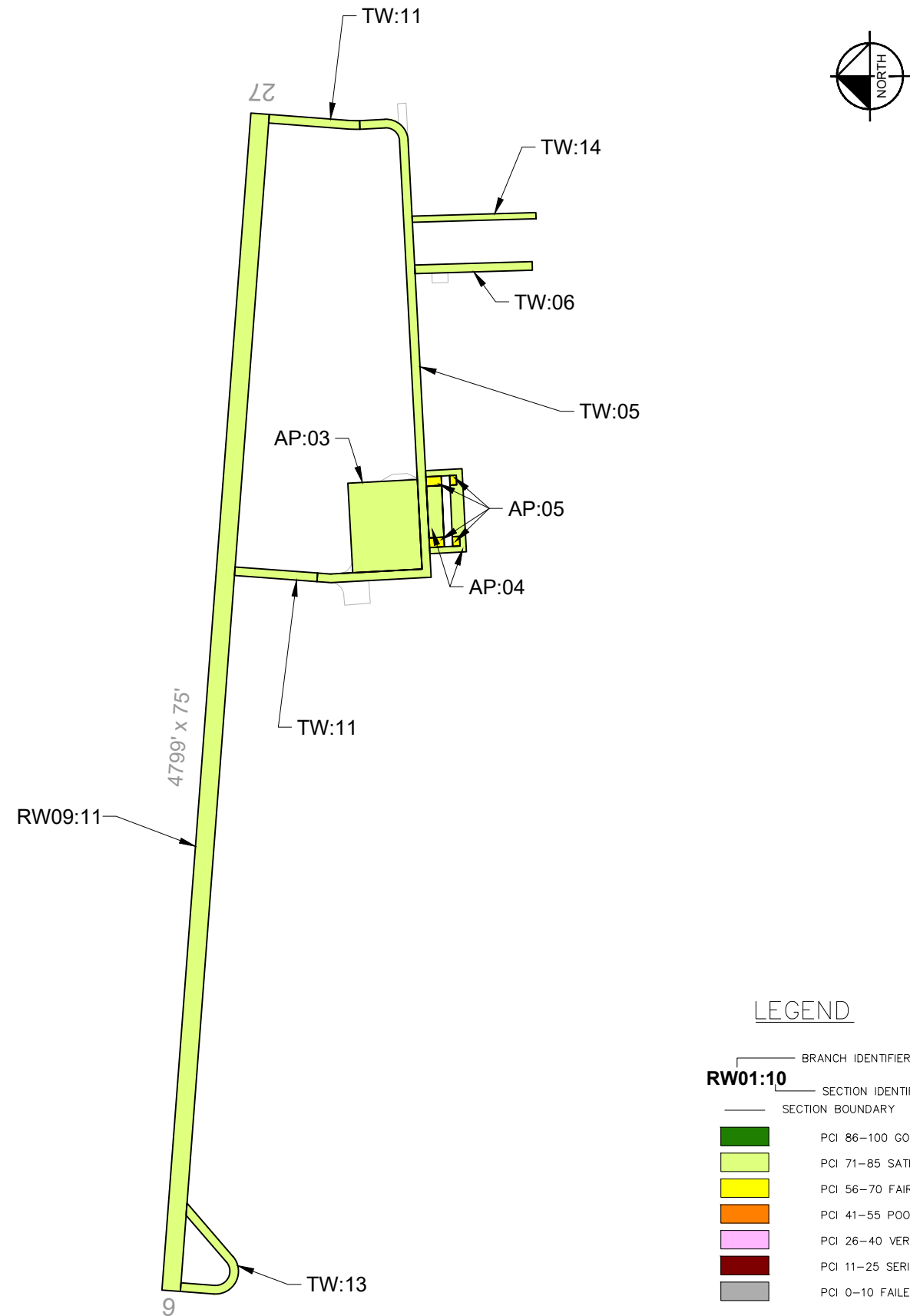

FORECASTED PAVEMENT CONDITION INDEX

Branch ID	Section ID	Surface Type	Current PCI (2024)	2025	2026	2027	2028	2029
RW09	11	AAC	81	81	80	78	78	77
TW	05	AAC	84	84	82	80	79	77
TW	06	AC	87	87	85	83	81	80
TW	11	AAC	81	81	79	78	76	75
TW	13	AAC	83	83	81	79	78	77
TW	14	AAC	86	86	84	82	80	79
AP	03	AC	86	86	83	81	80	78
AP	04	AC	79	79	77	76	74	73
AP	05	AC	74	74	73	71	70	69

This document, together with the concepts and designs presented herein, as an instrument of service, is intended only for the specific purpose and client for which it was prepared. Reuse of and improper reliance on this document without written authorization and adaptation by Kinney-Horn and Associates, Inc. shall be without liability to Kinney-Horn and Associates, Inc.

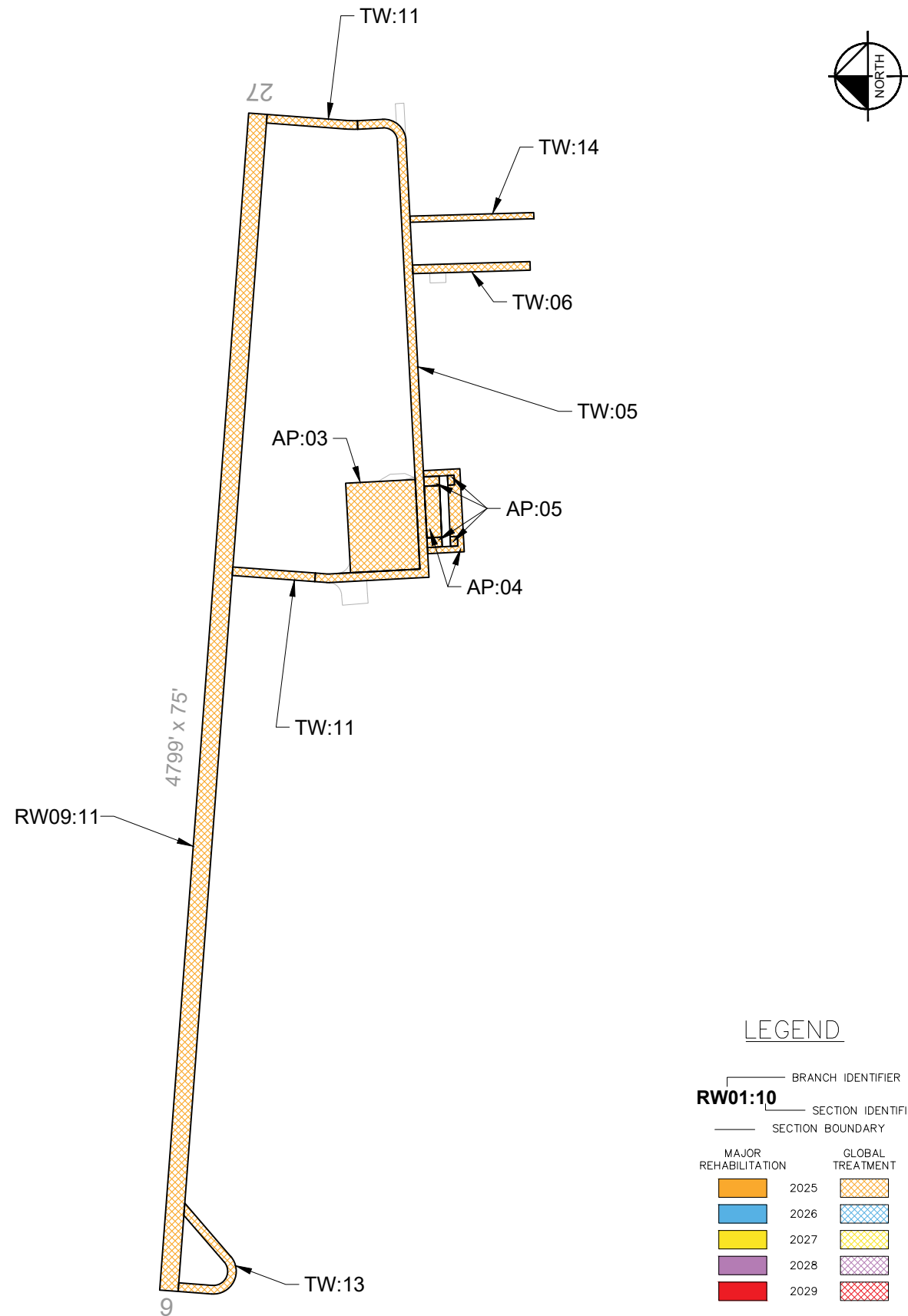

5-YEAR PAVEMENT NEEDS BY SECTION

Year	Branch ID	Section ID	Surface Type	Section Area (SF)	PCI at Treatment	Recommended Treatment	Treatment Category
2025	RW09	11	AAC	359,925	81	Crack Seal and Seal Coat	Global Treatment
2025	TW	05	AAC	84,824	84	Crack Seal and Seal Coat	Global Treatment
2025	TW	06	AC	16,730	87	Crack Seal and Seal Coat	Global Treatment
2025	TW	11	AAC	24,570	81	Crack Seal and Seal Coat	Global Treatment
2025	TW	13	AAC	20,458	83	Crack Seal and Seal Coat	Global Treatment
2025	TW	14	AAC	12,400	86	Crack Seal and Seal Coat	Global Treatment
2025	AP	03	AC	103,478	86	Crack Seal and Seal Coat	Global Treatment
2025	AP	04	AC	33,550	79	Crack Seal and Seal Coat	Global Treatment
2025	AP	05	AC	6,995	74	Crack Seal and Seal Coat	Global Treatment

Runway



RW09-11-20: Overview



RW09-11-64: L&T Cracking

Taxiway



TW-06-01: Weathering



TW-13-04: L&T Cracking

Apron



AP-03-10: L&T Cracking



AP-04-05: Patching

Re-Inspection Report

MDT SASP 2024

Generated Date 1/7/2025

Page 1 of 9

Network: 1S3 **Name:** Tillitt Field

Branch: AP **Name:** Apron **Use:** APRON **Area:** 144,023 SqFt

Section: 03 of 3 **From:** APRON **To:** APRON **Last Const.:** 11/14/2016

Surface: AC **Family:** _MDT2024 - AP AC **Zone:** **Category:** **Rank:** P

Area: 103,478 SqFt **Length:** 365 Ft **Width:** 283 Ft

Slabs: **Slab Length:** Ft **Slab Width:** Ft **Joint Length:** Ft

Shoulder: **Street Type:** **Grade:** 0 **Lanes:** 0

Section Comments:

Work Date: 11/14/2016 **Work Type:** New Construction - AC **Code:** NC-AC **Is Major M&R:** True

Work Date: 7/1/2020 **Work Type:** Surface Seal **Code:** SS-LO **Is Major M&R:** False

Work Date: 7/1/2020 **Work Type:** Crack Sealing - AC **Code:** CS-AC **Is Major M&R:** False

Last Insp. Date: 10/12/2024 **TotalSamples:** 20 **Surveyed:** 5

Conditions: PCI: 86

Inspection Comments:

Sample Number: 02 **Type:** R **Area:** 4928.00 SqFt **PCI:** 91

Sample Comments:

57 WEATHERING L 4682.00 SqFt
57 WEATHERING M 246.00 SqFt

Sample Number: 06 **Type:** R **Area:** 4928.00 SqFt **PCI:** 86

Sample Comments:

48 L & T CR L 49.00 Ft
57 WEATHERING L 4682.00 SqFt
57 WEATHERING M 246.00 SqFt

Sample Number: 10 **Type:** R **Area:** 4928.00 SqFt **PCI:** 86

Sample Comments:

48 L & T CR L 68.00 Ft
57 WEATHERING L 4682.00 SqFt
57 WEATHERING M 246.00 SqFt

Sample Number: 14 **Type:** R **Area:** 4928.00 SqFt **PCI:** 84

Sample Comments:

48 L & T CR L 95.00 Ft
57 WEATHERING L 4682.00 SqFt
57 WEATHERING M 246.00 SqFt

Sample Number: 18 **Type:** R **Area:** 5656.00 SqFt **PCI:** 86

Sample Comments:

48 L & T CR L 80.00 Ft
57 WEATHERING L 4682.00 SqFt
57 WEATHERING M 246.00 SqFt

Network: 1S3 **Name:** Tillitt Field

Branch: AP **Name:** Apron **Use:** APRON **Area:** 144,023 SqFt

Section: 04 of 3 **From:** T-5 **To:** HANGAR **Last Const.:** 11/14/2016

Surface: AC **Family:** _MDT2024 - AP AC **Zone:** **Category:** **Rank:** P

Area: 33,550 SqFt **Length:** 1,004 Ft **Width:** 25 Ft

Slabs: **Slab Length:** Ft **Slab Width:** Ft **Joint Length:** Ft

Shoulder: **Street Type:** **Grade:** 0 **Lanes:** 0

Section Comments:

Work Date: 11/14/2016 **Work Type:** New Construction - AC **Code:** NC-AC **Is Major M&R:** True

Work Date: 7/1/2020 **Work Type:** Surface Seal **Code:** SS-LO **Is Major M&R:** False

Work Date: 7/1/2020 **Work Type:** Crack Sealing - AC **Code:** CS-AC **Is Major M&R:** False

Last Insp. Date: 10/12/2024 **TotalSamples:** 7 **Surveyed:** 4

Conditions: PCI: 79

Inspection Comments:

Sample Number: 01 **Type:** R **Area:** 4689.00 SqFt **PCI:** 85

Sample Comments:

45 DEPRESSION L 12.00 SqFt

48 L & T CR L 42.00 Ft

57 WEATHERING L 4455.00 SqFt

57 WEATHERING M 234.00 SqFt

Sample Number: 03 **Type:** R **Area:** 5902.00 SqFt **PCI:** 84

Sample Comments:

48 L & T CR L 112.00 Ft

57 WEATHERING L 5607.00 SqFt

57 WEATHERING M 295.00 SqFt

Sample Number: 05 **Type:** R **Area:** 4310.00 SqFt **PCI:** 72

Sample Comments:

48 L & T CR L 38.00 Ft

50 PATCHING L 450.00 SqFt

57 WEATHERING L 4094.00 SqFt

57 WEATHERING M 216.00 SqFt

Sample Number: 07 **Type:** R **Area:** 4310.00 SqFt **PCI:** 73

Sample Comments:

48 L & T CR L 19.00 Ft

50 PATCHING L 450.00 SqFt

57 WEATHERING L 4094.00 SqFt

57 WEATHERING M 216.00 SqFt

Network:	1S3	Name:	Tillitt Field					
Branch:	AP	Name:	Apron	Use:	APRON	Area:	144,023 SqFt	
Section:	05	of 3	From:	AP04	To:	TW05	Last Const.:	1/1/2000
Surface:	AC	Family:	_MDT2024 - AP AC	Zone:		Category:	Rank:	P
Area:	6,995 SqFt	Length:	92 Ft	Width:	78 Ft			
Slabs:		Slab Length:	Ft	Slab Width:	Ft	Joint Length:	Ft	
Shoulder:		Street Type:		Grade:	0	Lanes:	0	
Section Comments:								
Work Date:	1/1/2000	Work Type:	New Construction - AC	Code:	NC-AC	Is Major M&R:	True	
Last Insp. Date:	10/12/2024	TotalSamples:	4	Surveyed:	3			
Conditions:	PCI: 74							
Inspection Comments:								
Sample Number:	01	Type:	R	Area:	2384.00 SqFt	PCI:	75	
Sample Comments:								
48	L & T CR	M	45.00 Ft					
57	WEATHERING	M	2384.00 SqFt					
Sample Number:	02	Type:	R	Area:	2427.00 SqFt	PCI:	75	
Sample Comments:								
48	L & T CR	M	20.00 Ft					
57	WEATHERING	M	2427.00 SqFt					
Sample Number:	03	Type:	R	Area:	1142.00 SqFt	PCI:	70	
Sample Comments:								
45	DEPRESSION	L	10.00 SqFt					
48	L & T CR	M	25.00 Ft					
57	WEATHERING	M	1142.00 SqFt					

Network:	1S3	Name:	Tillitt Field						
Branch:	RW09	Name:	Runway 09-27	Use:	RUNWAY	Area:	359,925 SqFt		
Section:	11	of	1	From:	RWY 26-8 STA 0+00	To:	RWY 26-8 STA 48+00	Last Const.:	10/23/2015
Surface:	AAC	Family:	_MDT2024 - RW AC AAC		Zone:	Category:	Rank: P		
Area:	359,925 SqFt	Length:	4,799 Ft	Width:	75 Ft				
Slabs:	Slab Length:	Ft	Slab Width:	Ft	Joint Length:	Ft			
Shoulder:	Street Type:	Grade:	0	Lanes:	0				
Section Comments:									
Work Date:	10/23/2015	Work Type:	New Construction - Initial		Code:	NU-IN	Is Major M&R:	True	
Work Date:	7/1/2020	Work Type:	Crack Sealing - AC		Code:	CS-AC	Is Major M&R:	False	
Work Date:	7/1/2020	Work Type:	Surface Seal		Code:	SS-LO	Is Major M&R:	False	
Last Insp. Date:	10/12/2024	TotalSamples:	74	Surveyed:	7				
Conditions:	PCI: 81	Inspection Comments:							
Sample Number:	09	Type:	R	Area:	4875.00 SqFt	PCI:	82		
Sample Comments:									
48	L & T CR	L	140.00	Ft					
57	WEATHERING	L	4631.00	SqFt					
57	WEATHERING	M	244.00	SqFt					
Sample Number:	20	Type:	R	Area:	4875.00 SqFt	PCI:	84		
Sample Comments:									
48	L & T CR	L	95.00	Ft					
57	WEATHERING	L	4631.00	SqFt					
57	WEATHERING	M	244.00	SqFt					
Sample Number:	31	Type:	R	Area:	4875.00 SqFt	PCI:	85		
Sample Comments:									
48	L & T CR	L	81.00	Ft					
57	WEATHERING	L	4631.00	SqFt					
57	WEATHERING	M	244.00	SqFt					
Sample Number:	42	Type:	R	Area:	4875.00 SqFt	PCI:	80		
Sample Comments:									
48	L & T CR	L	166.00	Ft					
57	WEATHERING	L	4631.00	SqFt					
57	WEATHERING	M	244.00	SqFt					
Sample Number:	53	Type:	R	Area:	4875.00 SqFt	PCI:	84		
Sample Comments:									
48	L & T CR	L	102.00	Ft					
57	WEATHERING	L	4631.00	SqFt					
57	WEATHERING	M	244.00	SqFt					
Sample Number:	64	Type:	R	Area:	4875.00 SqFt	PCI:	78		
Sample Comments:									
48	L & T CR	L	213.00	Ft					
57	WEATHERING	L	4631.00	SqFt					
57	WEATHERING	M	244.00	SqFt					
Sample Number:	74	Type:	R	Area:	4235.00 SqFt	PCI:	74		
Sample Comments:									
48	L & T CR	L	202.00	Ft					
52	RAVELING	L	42.00	SqFt					
57	WEATHERING	L	3991.00	SqFt					
57	WEATHERING	M	244.00	SqFt					

Network:	1S3	Name:	Tillitt Field				
Branch:	TW	Name:	Taxiway	Use:	TAXIWAY	Area:	158,982 SqFt
Section:	05	of 5	From:	T-1	To:	T-1	Last Const.: 11/14/2016
Surface:	AAC	Family:	_MDT2024 - TW AAC	Zone:		Category:	Rank: P
Area:	84,824 SqFt	Length:	2,426 Ft	Width:	35 Ft		
Slabs:		Slab Length:	Ft	Slab Width:	Ft	Joint Length:	Ft
Shoulder:		Street Type:		Grade:	0	Lanes:	0
Section Comments:							
Work Date:	11/14/2016	Work Type:	New Construction - Initial		Code:	NU-IN	Is Major M&R: True
Work Date:	7/1/2020	Work Type:	Crack Sealing - AC		Code:	CS-AC	Is Major M&R: False
Work Date:	7/1/2020	Work Type:	Surface Seal		Code:	SS-LO	Is Major M&R: False
Last Insp. Date:	10/12/2024	TotalSamples:	17	Surveyed:	5		
Conditions:	PCI: 84						
Inspection Comments:							
Sample Number:	02	Type:	R	Area:	4936.00 SqFt	PCI:	86
Sample Comments:							
48	L & T CR	L	30.00	Ft			
57	WEATHERING	L	4689.00	SqFt			
57	WEATHERING	M	247.00	SqFt			
Sample Number:	06	Type:	R	Area:	5005.00 SqFt	PCI:	83
Sample Comments:							
48	L & T CR	L	116.00	Ft			
57	WEATHERING	L	4689.00	SqFt			
57	WEATHERING	M	247.00	SqFt			
Sample Number:	10	Type:	R	Area:	5005.00 SqFt	PCI:	82
Sample Comments:							
48	L & T CR	L	144.00	Ft			
57	WEATHERING	L	4689.00	SqFt			
57	WEATHERING	M	247.00	SqFt			
Sample Number:	14	Type:	R	Area:	5005.00 SqFt	PCI:	82
Sample Comments:							
48	L & T CR	L	143.00	Ft			
57	WEATHERING	L	4689.00	SqFt			
57	WEATHERING	M	247.00	SqFt			
Sample Number:	16	Type:	R	Area:	4973.00 SqFt	PCI:	86
Sample Comments:							
48	L & T CR	L	56.00	Ft			
57	WEATHERING	L	4689.00	SqFt			
57	WEATHERING	M	247.00	SqFt			

Network: 1S3 **Name:** Tillitt Field

Branch: TW **Name:** Taxiway **Use:** TAXIWAY **Area:** 158,982 SqFt

Section: 06 of 5 **From:** T-5 **To:** HANGARS **Last Const.:** 11/14/2016

Surface: AC **Family:** _MDT2024 - TW AC **Zone:** **Category:** **Rank:** P

Area: 16,730 SqFt **Length:** 478 Ft **Width:** 35 Ft

Slabs: **Slab Length:** Ft **Slab Width:** Ft **Joint Length:** Ft

Shoulder: **Street Type:** **Grade:** 0 **Lanes:** 0

Section Comments:

Work Date: 11/14/2016 **Work Type:** New Construction - AC **Code:** NC-AC **Is Major M&R:** True

Work Date: 7/1/2020 **Work Type:** Surface Seal **Code:** SS-LO **Is Major M&R:** False

Work Date: 7/1/2020 **Work Type:** Crack Sealing - AC **Code:** CS-AC **Is Major M&R:** False

Last Insp. Date: 10/12/2024 **TotalSamples:** 4 **Surveyed:** 3

Conditions: PCI: 87

Inspection Comments:

Sample Number: 01 **Type:** R **Area:** 4168.00 SqFt **PCI:** 86

Sample Comments:

48 L & T CR L 48.00 Ft

57 WEATHERING L 3960.00 SqFt

57 WEATHERING M 208.00 SqFt

Sample Number: 02 **Type:** R **Area:** 4183.00 SqFt **PCI:** 88

Sample Comments:

48 L & T CR L 6.00 Ft

57 WEATHERING L 3974.00 SqFt

57 WEATHERING M 209.00 SqFt

Sample Number: 04 **Type:** R **Area:** 4197.00 SqFt **PCI:** 87

Sample Comments:

45 DEPRESSION L 21.00 SqFt

57 WEATHERING L 3987.00 SqFt

57 WEATHERING M 210.00 SqFt

Network: 1S3 **Name:** Tillitt Field

Branch: TW **Name:** Taxiway **Use:** TAXIWAY **Area:** 158,982 SqFt

Section: 11 of 5 **From:** R-11 **To:** T-5 **Last Const.:** 10/23/2015

Surface: AAC **Family:** _MDT2024 - TW AAC **Zone:** **Category:** **Rank:** P

Area: 24,570 SqFt **Length:** 702 Ft **Width:** 35 Ft

Slabs: **Slab Length:** Ft **Slab Width:** Ft **Joint Length:** Ft

Shoulder: **Street Type:** **Grade:** 0 **Lanes:** 0

Section Comments:

Work Date: 10/23/2015 **Work Type:** New Construction - Initial **Code:** NU-IN **Is Major M&R:** True

Work Date: 7/1/2020 **Work Type:** Surface Seal **Code:** SS-LO **Is Major M&R:** False

Work Date: 7/1/2020 **Work Type:** Crack Sealing - AC **Code:** CS-AC **Is Major M&R:** False

Last Insp. Date: 10/12/2024 **TotalSamples:** 6 **Surveyed:** 3

Conditions: PCI: 81

Inspection Comments:

Sample Number: 02 **Type:** R **Area:** 4375.00 SqFt **PCI:** 80

Sample Comments:

48 L & T CR L 157.00 Ft
57 WEATHERING L 4156.00 SqFt
57 WEATHERING M 219.00 SqFt

Sample Number: 04 **Type:** R **Area:** 2923.00 SqFt **PCI:** 75

Sample Comments:

48 L & T CR L 22.00 Ft
57 WEATHERING M 2777.00 SqFt
57 WEATHERING M 146.00 SqFt

Sample Number: 06 **Type:** R **Area:** 4437.00 SqFt **PCI:** 86

Sample Comments:

48 L & T CR L 30.00 Ft
57 WEATHERING L 4215.00 SqFt
57 WEATHERING M 222.00 SqFt

Network: 1S3 **Name:** Tillitt Field

Branch: TW **Name:** Taxiway **Use:** TAXIWAY **Area:** 158,982 SqFt

Section: 13 of 5 **From:** R-1 **To:** R-1 **Last Const.:** 10/23/2015

Surface: AAC **Family:** _MDT2024 - TW AAC **Zone:** **Category:** **Rank:** P

Area: 20,458 SqFt **Length:** 584 Ft **Width:** 35 Ft

Slabs: **Slab Length:** Ft **Slab Width:** Ft **Joint Length:** Ft

Shoulder: **Street Type:** **Grade:** 0 **Lanes:** 0

Section Comments:

Work Date: 10/23/2015 **Work Type:** New Construction - Initial **Code:** NU-IN **Is Major M&R:** True

Work Date: 7/1/2020 **Work Type:** Crack Sealing - AC **Code:** CS-AC **Is Major M&R:** False

Work Date: 7/1/2020 **Work Type:** Surface Seal **Code:** SS-LO **Is Major M&R:** False

Last Insp. Date: 10/12/2024 **TotalSamples:** 4 **Surveyed:** 3

Conditions: PCI: 83

Inspection Comments:

Sample Number: 01 **Type:** R **Area:** 4900.00 SqFt **PCI:** 81

Sample Comments:

48 L & T CR L 29.00 Ft
48 L & T CR M 10.00 Ft
57 WEATHERING L 4655.00 SqFt
57 WEATHERING M 245.00 SqFt

Sample Number: 03 **Type:** R **Area:** 4900.00 SqFt **PCI:** 81

Sample Comments:

48 L & T CR L 155.00 Ft
57 WEATHERING L 4655.00 SqFt
57 WEATHERING M 245.00 SqFt

Sample Number: 04 **Type:** R **Area:** 5717.00 SqFt **PCI:** 85

Sample Comments:

48 L & T CR L 90.00 Ft
57 WEATHERING L 5431.00 SqFt
57 WEATHERING M 286.00 SqFt

Network: 1S3 **Name:** Tillitt Field

Branch: TW **Name:** Taxiway **Use:** TAXIWAY **Area:** 158,982 SqFt

Section: 14 of 5 **From:** T-5 **To:** HANGARS **Last Const.:** 11/14/2016

Surface: AAC **Family:** _MDT2024 - TW AAC **Zone:** **Category:** **Rank:** P

Area: 12,400 SqFt **Length:** 496 Ft **Width:** 25 Ft

Slabs: **Slab Length:** Ft **Slab Width:** Ft **Joint Length:** Ft

Shoulder: **Street Type:** **Grade:** 0 **Lanes:** 0

Section Comments:

Work Date: 11/14/2016 **Work Type:** New Construction - Initial **Code:** NU-IN **Is Major M&R:** True

Work Date: 7/1/2020 **Work Type:** Crack Sealing - AC **Code:** CS-AC **Is Major M&R:** False

Work Date: 7/1/2020 **Work Type:** Surface Seal **Code:** SS-LO **Is Major M&R:** False

Last Insp. Date: 10/12/2024 **TotalSamples:** 3 **Surveyed:** 3

Conditions: PCI: 86

Inspection Comments:

Sample Number: 01 **Type:** R **Area:** 4200.00 SqFt **PCI:** 86

Sample Comments:

48 L & T CR L 33.00 Ft
57 WEATHERING L 3990.00 SqFt
57 WEATHERING M 210.00 SqFt

Sample Number: 02 **Type:** R **Area:** 4200.00 SqFt **PCI:** 86

Sample Comments:

48 L & T CR L 32.00 Ft
57 WEATHERING L 3990.00 SqFt
57 WEATHERING M 210.00 SqFt

Sample Number: 03 **Type:** R **Area:** 4000.00 SqFt **PCI:** 85

Sample Comments:

48 L & T CR L 62.00 Ft
57 WEATHERING L 3800.00 SqFt
57 WEATHERING M 200.00 SqFt